

BLACK THERMOPLASTIC RUBBER WHEELS WITH POLYPROPYLENE CENTRE

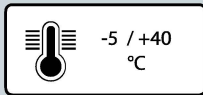

Description

Tyre: black thermoplastic rubber.

Centre: polypropylene.

Hub with plain bore hole which directly houses the axle.

Uses

Mainly suitable for static applications, on even flooring and for light carrying capacities.

Example of recommended applications: compressors, welding machines.

Environments of use

Suitable for industrial and institutional environments, also in presence of humidity. Not suitable in the presence of organic solvents, chlorinated substances, hydrocarbons and mineral oils.

WEAK ACIDS		WEAK BASES	
STRONG ACIDS		STRONG BASES	
WATER		HYDROCARBONS	
ALCOHOL		SOLVENTS	

For information on the compatibility of the component wheel materials with specific aggressive chemical substances, see table at page 36.







Floors

Suitable on tiles and resin-cement; not recommended on abrasive, unpaved floors or in presence of processing residues.

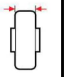
Not suitable for uneven surfaces.



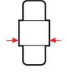





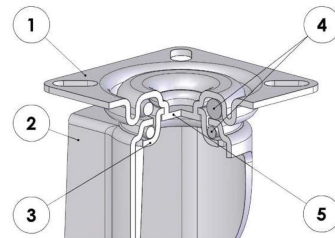

														
mm	mm	kg	CODE	mm	mm	daN								
80	26	0.09	511101	10	34	30								
100	30	0.11	511112	8	35	35								
100	30	0.11	511122	12	35	35								
125	35	0.18	511103	15	44	50								
150	35	0.23	511104	15	44	90								
175	45	0.33	511105	20	59	100								
200	50	0.72	511106	20	59	120								
250	50	0.89	511108	20	59	120								

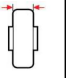
Institutional brackets

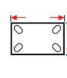
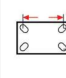
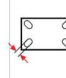

- 1) Plate: electrolytically galvanised steel plate
- 2) Fork: electrolytically galvanised steel plate
- 3) Ball race ring: electrolytically galvanised steel plate
- 4) Swivel actions: double ball ring with grease lubrication
- 5) King pin: integrated with the plate and cold-riveted

															
mm	mm	kg	CODE	mm	mm	mm	mm	mm	daN						
80	26	0.43	514411	106	60x60	45x45	6	28	30						
100	30	0.48	514412	128	60x60	45x45	6	32	35						

Institutional brackets

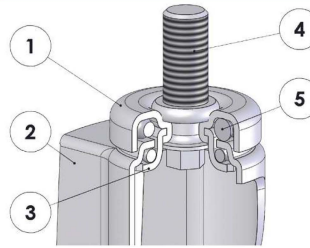

- 1) Plate: electrolytically galvanised steel plate
- 2) Fork: electrolytically galvanised steel plate
- 3) Ball race ring: electrolytically galvanised steel plate
- 4) Galvanised steel threaded stem
- 5) Swivel actions: double ball ring with grease lubrication

mm	mm	kg	CODE	mm	mm	mm	mm	mm	daN
80	26	0.35	516801	103	41	M12	25	28	30
100	30	0.40	516802	126	41	M12	25	32	35

Standard-duty brackets NL - max carrying capacity 90 daN

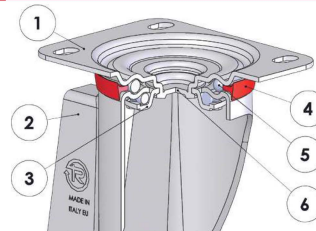

- 1) Plate: electrolytically galvanised steel plate
- 2) Fork: electrolytically galvanised steel plate
- 3) Ball race ring: electrolytically galvanised steel plate
- 4) Dust seal: orange polyethylene
- 5) Swivel actions: double ball ring with grease lubrication
- 6) King pin: integrated with the plate and cold-riveted

mm	mm	kg	CODE	kg	CODE	mm	mm	mm	mm	mm	kg
80	26	0.62	514401	0.34	515701	107	100x85	80x60	9	37	30
100	30	0.63	514402	0.37	515702	128	100x85	80x60	9	35	35
125	35	0.82	514403	0.48	515703	156	100x85	80x60	9	37	50
150	35	0.91	514404	0.54	515704	182	100x85	80x60	9	42	90